



FITTING INSTRUCTIONS FOR ECG0005SI ENGINE CASE GUARDS
HUSQVARNA FS 450 2015



PICTURE 'A'



PICTURE 'B'

THIS KIT CONTAINS THE ITEMS PICTURED AND LABELLED BELOW.
DO NOT PROCEED UNTIL YOU ARE SURE ALL PARTS ARE PRESENT.

Please note that the way the kit is packed does not necessarily represent the way of mounting to the bike

THE PARTS SHOWN MAY BE REPRESENTATIVE ONLY (FOR CLARITY OF INSTRUCTIONS ONLY)

TOOLS REQUIRED

- Socket set.
- Allen keys.

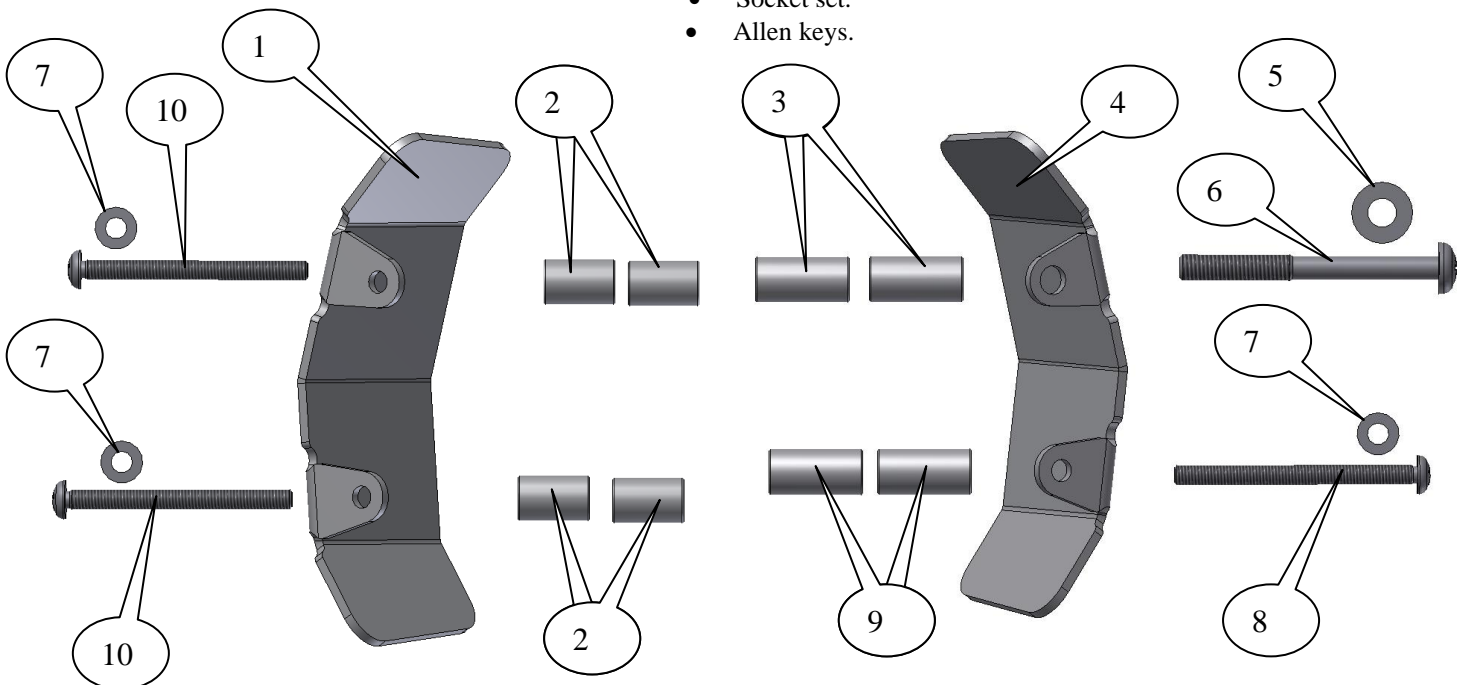

LEFT HAND SIDE

RIGHT HAND SIDE

R&G Racing

Unit 1 Shelleys Lane, East Worldham, Alton, Hants GU34 3AQ

Tel: +44 (0)1420 89007 Fax: +44 (0)1420 87301 www.rg-racing.com Email: info@rg-racing.com



LEGEND

- ITEM 1 = SMW0049 ENGINE CASE GUARD (LEFT HAND SIDE) (x1).
- ITEM 2 = S0851 UPPER AND LOWER SPACERS (LEFT HAND SIDE) (22mm LONG) (x4).
- ITEM 3 = S0853 UPPER SPACERS (RIGHT HAND SIDE) (29mm LONG) (x2).
- ITEM 4 = SMW0050 ENGINE CASE GUARD (RIGHT HAND SIDE) (x1).
- ITEM 5 = M8 PLAIN WASHER (x1).
- ITEM 6 = M8x110mm LONG BUTTON HEAD BOLT (x1).
- ITEM 7 = M6 PLAIN WASHERS (x3).
- ITEM 8 = M6x85mm LONG BUTTON HEAD BOLT (x1).
- ITEM 9 = S0852 LOWER SPACERS (RIGHT HAND SIDE) (29mm LONG) (x2).
- ITEM 10 = M6x70mm LONG BUTTON HEAD BOLTS (x2).

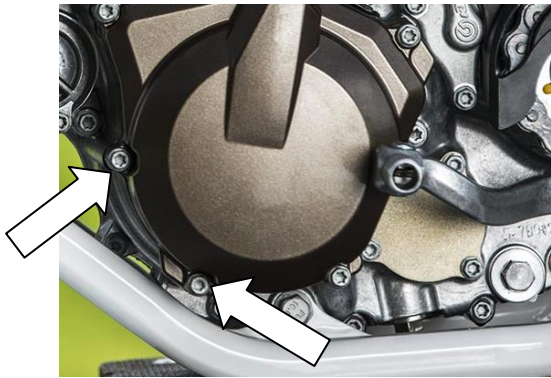

PICTURE 1

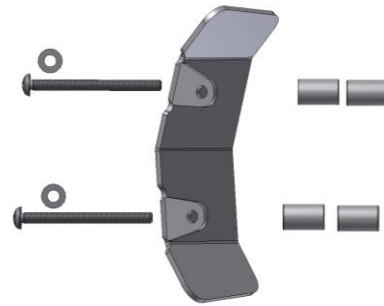

PICTURE 2

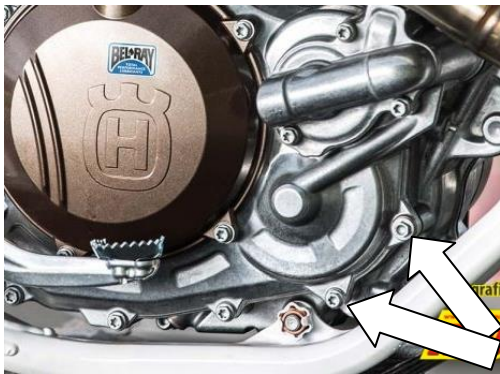

PICTURE 3

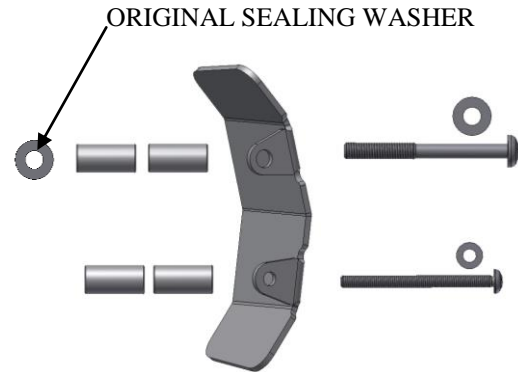

PICTURE 4

FITTING INSTRUCTIONS

Near side (left side as you sit on bike)

- Remove the two bolts arrowed in picture 1.
- Place one of the M6 washers (item 7) onto one of the shortest M6 bolts (item 10=70mm long) then place through the left hand side engine case guard upper hole (item 1= the one with the mounting holes closer together), then place two of the shortest spacers (item 2=22mm long) over the protruding bolt as shown in picture 2.
- Place one of the M6 washers (item 7) onto one of the shortest M6 bolts (item 10=70mm long) then place through the left hand side engine case guard lower hole (item 1= the one with the

R&G Racing



mounting holes closer together), then place two of the shortest spacers (item 2=22mm long) over the protruding bolt as shown in picture 2.

- Offer the assembly into position as shown below and tighten both bolts.



Off side (right side as you sit on bike)

- Remove the two bolts arrowed in picture 3 (please note the upper bolt has a sealing washer, please keep for reassembly).
- Place the M8 washers (item 5) onto the shortest M8 bolt (item 6=110mm long), then place through the right hand side engine case guard upper/largest hole (item 4= the one with the mounting holes further apart), then place two of the longest spacers with the larger holes (item 3=29mm long) over the protruding bolt as shown in picture 4, then place the sealing washer onto the bolt so it sits against the last spacer just fitted.
- Place one of the M6 washers (item 7) onto the longest M6 bolt (item 8=85mm long) then place through the lower hole, then place two of the two remaining spacers (with the smaller holes (item 9=29mm long) over the protruding bolt as shown in picture 4.
- Offer the assembly into position as shown below and tighten both bolts.



ISSUE 1 10/07/2015 (NSY)

R&G Racing

Unit 1 Shelleys Lane, East Worldham, Alton, Hants GU34 3AQ

Tel: +44 (0)1420 89007 Fax: +44 (0)1420 87301 www.rg-racing.com Email: info@rg-racing.com



**INSTRUCTIONS DE MONTAGE POUR ECG0005SI PROTECTIONS CRASH
HUSQVARNA FS 450 2015**



PHOTO 'A'



PHOTO 'B'

**Le kit contient les articles exposés ci-dessous, vérifier que toutes les pièces soient
présentes avant de procéder au montage.**

La façon dont le kit est emballé ne correspond pas forcément à la façon de monter les pièces sur
la moto.

**LES PARTIES PRESENTES PEUVENT ETRE UNIQUEMENT REPRESENTATIVES
(POUR LA CLARTE DES INSTRUCTIONS UNIQUEMENT).**

OUTILS REQUIS :

- Jeu de clés.
- Clés Allen.

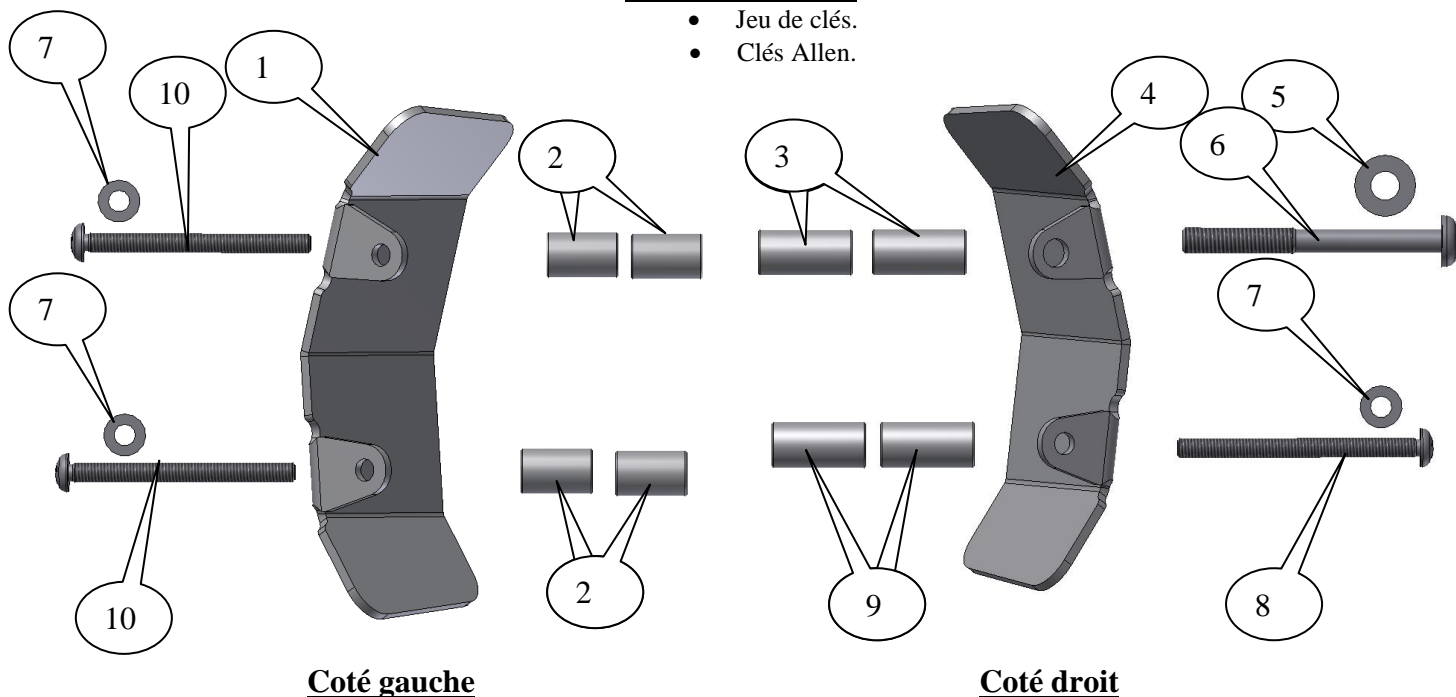

Coté gauche

Coté droit

R&G Racing

Unit 1 Shelleys Lane, East Worldham, Alton, Hants GU34 3AQ

Tel: +44 (0)1420 89007 Fax: +44 (0)1420 87301 www.rg-racing.com Email: info@rg-racing.com



LEGENDE

ARTICLE 1 = SMW0049 PROTECTION (COTE GAUCHE) (x1).

ARTICLE 2 = S0851 ENTRETOISES SUPERIEURES ET INFERIEURES (COTE GAUCHE) (22mm LONG) (x4).

ARTICLE 3 = S0853 ENTRETOISES SUPERIEURES (COTE DROIT) (29mm DE LONG) (x2).

ARTICLE 4 = SMW0050 PROTECTION CARTER MOTEUR (COTE DROIT) (x1).

ARTICLE 5 = M8 RONDELLE (x1).

ARTICLE 6 = M8x110mm BOULON (x1).

ARTICLE 7 = M6 RONDELLES (x3).

ARTICLE 8 = M6x85mm BOULON (x1).

ARTICLE 9 = S0852 ENTRETOISES INFERIEURES (COTE DROIT) (29mm DE LONG) (x2).

ARTICLE 10 = M6x70mm BOULONS (x2).

Page | 5

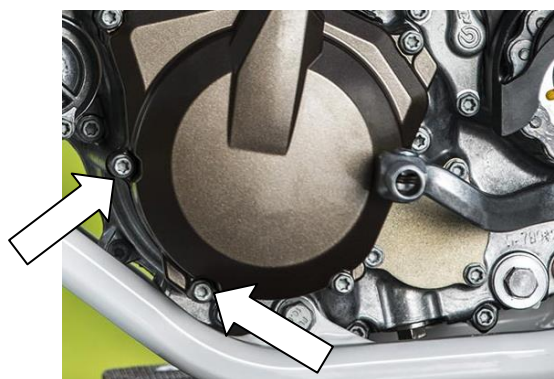

PHOTO 1

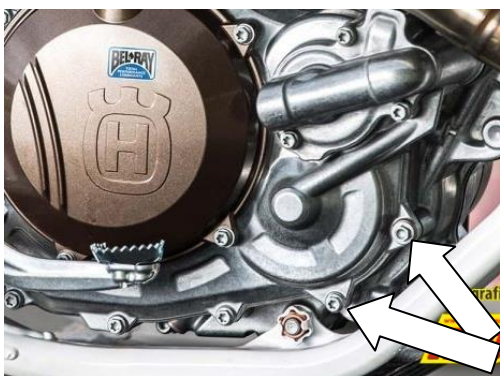

PHOTO 3

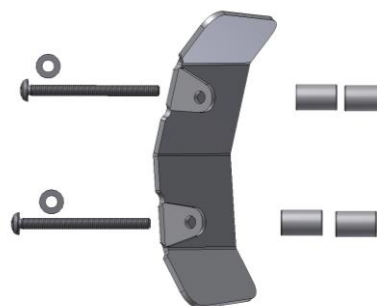

PHOTO 2

RONDELLE D'ETANCHEITE D'ORIGINE

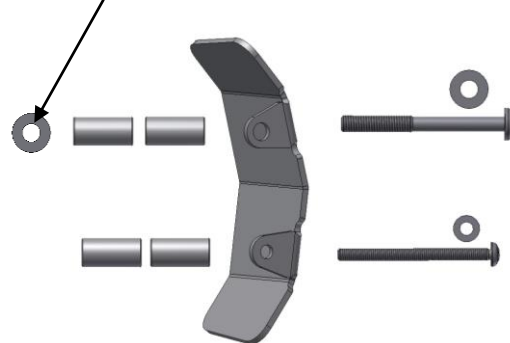

PHOTO 4

INSTRUCTIONS DE MONTAGE :

Coté gauche (lorsqu'on est assis sur la moto).

- Enlever les 2 boulons, voir photo 1.
- Placer une des rondelles M6 (article 7) sur un des boulons M6 (article 10=70mm de long) puis placez le dans le trou supérieur de la protection carter moteur coté gauche (article 1= celle dont les trous de fixation sont les plus proches les uns des autres), puis placer 2 entretoises courtes (article 2=22mm de long) sur le boulon dépassant, voir photo 2.

R&G Racing

Unit 1 Shelleys Lane, East Worldham, Alton, Hants GU34 3AQ

Tel: +44 (0)1420 89007 Fax: +44 (0)1420 87301 www.rg-racing.com Email: info@rg-racing.com



- Placer une des rondelles M6 (article 7) sur un des boulons M6 (article 10=70mm de long) puis dans le trou de fixation inférieur de la protection carter moteur coté gauche (article 1= celle dont les trous de fixation sont les plus proches les uns des autres), puis placer 2 des entretoises les plus courtes (article 2=22mm de long) sur le boulon dépassant, voir photo 2.
- Monter l'ensemble en position, comme indiqué ci-dessous, puis serrer les 2 boulons.

Page | 6



Coté droit (lorsqu'on est assis sur la moto).

- Enlever les 2 boulons, voir photo 3 (notez que le boulon supérieur possède une rondelle d'étanchéité, conservez la pour le réassemblage).
- Placer les rondelles M8 (article 5) sur le boulon le plus court M8 (article 6=110mm de long), puis placez le dans le trou de fixation supérieur/ le plus large de la protection carter moteur du coté droit (article 4= celle avec les trous de fixation les plus espacés), puis placer 2 des entretoises avec les trous les plus larges (article 3=29mm de long) sur le boulon dépassant, voir photo 4, puis placer la rondelle d'étanchéité sur le boulon de façon à ce qu'elle se place contre la dernière entretoise tout juste insérée.
- Placer une des rondelles M6 (article 7) sur le boulon le plus long M6 (article 8=85mm de long) puis placez le dans le trou inférieur, ainsi que 2 des entretoises restantes (avec les trous les plus petits (article 9=29mm de long) sur le boulon dépassant, voir photo 4.
- Monter l'ensemble en position, comme indiqué ci-dessous puis serrer les 2 boulons.



ISSUE 1 10/07/2015 (NSY)

CONSUMER NOTICE

The catalogue description and any exhibition of samples are only broad indications of the Products and R&G may make design changes which do not diminish their performance or visual appeal and supplying them in such state shall conform to the order. The Buyer acknowledges no representation or warranty (other than as to title) has been given or will apply to the Products other than those in R&G's order or confirmation and the Buyer confirms it has chosen the Products as being of merchantable quality and suitable for its particular purposes. Where R&G fits the Products or undertakes other services it shall exercise reasonable

R&G Racing

Unit 1 Shelleys Lane, East Worldham, Alton, Hants GU34 3AQ

Tel: +44 (0)1420 89007 Fax: +44 (0)1420 87301 www.rg-racing.com Email: info@rg-racing.com



skill and care and rectify any fault free of charge unless the workmanship has been disturbed. The Buyer is responsible for ensuring that the warranty on the motorcycle is not affected by the fitting of the Products. On return of any defective Products R&G shall at its option either supply a replacement or refund the purchase money but shall not be liable if the Products have been modified or used or maintained otherwise than in accordance with R&G's or manufacturer's instructions and good engineering practice or if the defect arises from accident or neglect. Other than identified above and subject to R&G not limiting its liability for causing death and personal injury, it shall not be liable for indirect or consequential loss and otherwise its liability shall be limited to the amounts paid by the Buyer for the Products or the fitting or service concerned. These terms do not affect the Buyer's statutory rights.

R&G RACING RETURNS POLICY (NON-FAULTY GOODS)

Returns must be pre-authorized (if not pre-authorized the return will be rejected). Goods may only be returned direct to us if they were purchased direct from us (customer must prove if necessary). Otherwise to be returned to original vendor. Goods must be in re-sellable condition, in the opinion of R&G Racing. All returns are subject to a 25% restocking and handling fee (25% of the gross value exc. P&P – at the prevailing price at time of purchase). The customer must pay any and all carriage charges. No returns of discontinued products, unless within 14 days of purchase. This policy does not affect your statutory rights and does not refer to faulty goods.

R&G Racing

Unit 1 Shelleys Lane, East Worldham, Alton, Hants GU34 3AQ

Tel: +44 (0)1420 89007 Fax: +44 (0)1420 87301 www.rg-racing.com Email: info@rg-racing.com